

**This product may be purchased from Connevens Limited secure online store
at www.DeafEquipment.co.uk**



DeafEquipment.co.uk

Solutions to improve the quality of life



EduLink™ S

User Guide



PHONAK
hearing systems

CE

Contents

Welcome	4
<hr/>	
Your EduLink S and accessories	6
<hr/>	
How your EduLink S works	7
<hr/>	
Getting started	8
Inserting a new battery	8
Switching ON or OFF and adjusting the volume	10
How to wear the EduLink S	12
Functional test	14
Operating range	16
<hr/>	
Care and maintenance	17
Replacing the earpiece cover	17
Fitting the childproof battery cover (optional)	22
<hr/>	
Changing the FM channel	25
<hr/>	
Important notes	26
<hr/>	
Declaration of conformity	27
<hr/>	
Service and Warranty	28
<hr/>	
Phonak distributors worldwide	29
<hr/>	

Welcome

EduLink S is a special radio receiver for use in conjunction with a radio transmitter. An EduLink S wearer hears the speaker's voice loud and clear.

This User Guide helps you to obtain maximum benefit from EduLink S. Should you have further questions, the EduLink fitter will be pleased to help.

Phonak wishes you happy hearing with EduLink S.

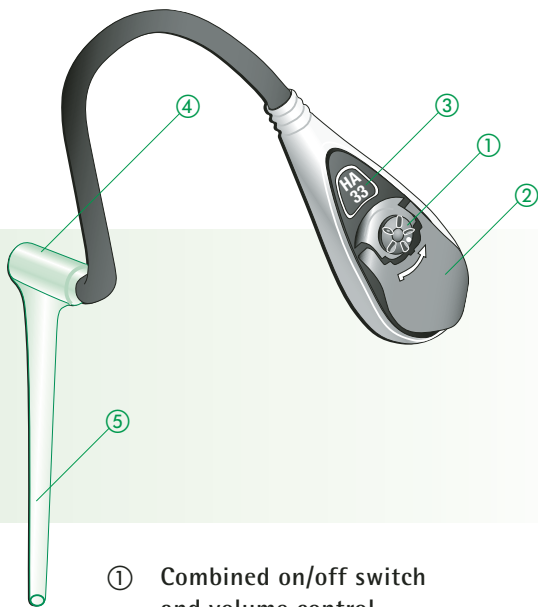

- ① Combined on/off switch and volume control
 - Turn clockwise:
Switch on → Increase volume
 - Turn counter-clockwise:
Decrease volume → Switch off
- ② Battery compartment cover
- ③ Sticker with default channel identification
- ④ Earpiece
- ⑤ Retention lock

Your EduLink S and accessories

① EduLink S _____



② Storage and carrying case _____



③ Campus S with microphone, or other FM transmitter _____



④ Charger for FM transmitter _____ a)

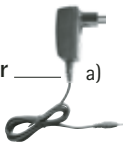

⑤ Set of replacement earpiece covers _____



⑥ Spare batteries _____ b)



⑦ Childproof battery compartment cover

- a) Charger may differ, depending on the FM transmitter in use.
- b) Additional replacement batteries and earpiece covers are available separately.

How your EduLink S works

The teacher wears a compact microphone and radio transmitter, such as the Campus S. The child wears the EduLink S directly on the ear. The microphone picks up the teacher's voice and instantly relays it by radio directly to the EduLink S on the child's ear. The child always hears the teacher's voice loud and clear, even in a noisy environment.



Getting started:

Inserting a new battery

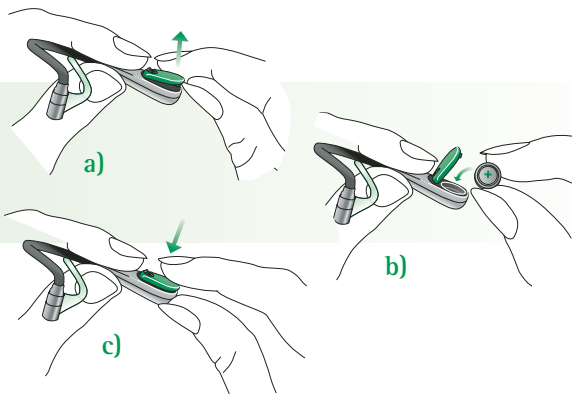

- a) Carefully open the battery compartment cover and remove the used battery.
- b) Insert a new battery (type 312) into the battery compartment. Ensure that the side with the + sign faces upwards.
- c) Gently close the battery compartment cover until it clicks into place.

- Battery operating life is around 30- 40 hours. Phonak recommends replacing the battery at regular intervals. When the battery is depleted, the EduLink S produces audible noise to alert the wearer.
- Batteries must be disposed of properly. Used batteries can also be returned to the place of purchase for disposal.

 Hearing instrument batteries are toxic when swallowed! Keep them out of reach of children and pets. If batteries are swallowed, please seek immediate advice from a medical practitioner!

Switching ON or OFF and adjusting the volume

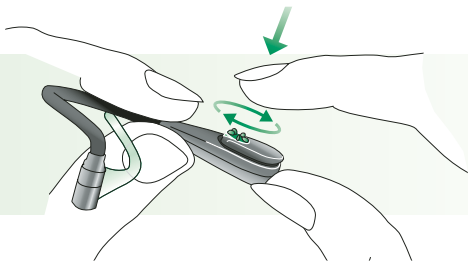

Switching ON:

- Turn the volume control clockwise (in the direction shown by the arrow). Always switch on EduLink S first, then the FM transmitter.

Adjusting the volume:

- Turn clockwise: to increase volume.
- Turn counterclockwise: to decrease volume.

Switching OFF:

- Turn the volume control counterclockwise to the end stop.

- Your EduLink S features an automatic switch-off (sleep mode). When the FM transmitter is switched off, after about 40 seconds EduLink S automatically enters sleep mode and uses practically no energy. When the FM receiver is switched on again, EduLink S returns to normal operation within a few seconds.

Sleep mode makes it unnecessary to manually switch off EduLink S during classroom breaks.

How to wear the EduLink S

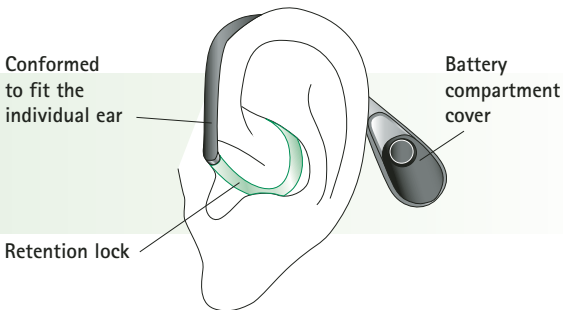

- Ensure that the retention lock rests in the ear as illustrated. The metal tip of the earpiece inserts into the ear canal.
- To ensure a good fit, the flexible black tube must be bent to conform to the individual ear shape.
- For comfort, EduLink S should be worn so that the battery compartment cover faces away from the head.

- If you detach the retention lock, be sure to refit it as shown, using a gentle twisting motion.

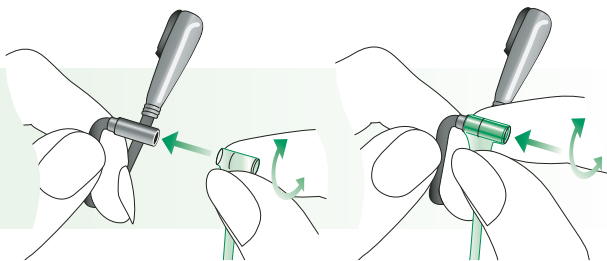

⚠ Never wear EduLink S without a retention lock, and be sure not to poke the retention lock down the ear canal!

Functional test

- a) Switch on EduLink S and turn up the volume.
- b) Switch on the FM transmitter (for example a Campus S). Ask someone to speak into it, or connect the transmitter to a CD player. (Refer to the User Guide for the FM transmitter.)
- c) Insert EduLink S in the ear and move 2 to 3 meters away from the speaker or the CD player.

You should now hear speech or music broadcast by the FM transmitter in EduLink S.

Should you hear nothing, proceed as follows:

- Ensure that the FM transmitter frequency channel (indicated in the Campus S LCD, e.g. "33") matches the EduLink S frequency channel (number printed on the sticker adjacent to the battery compartment cover).
- Replace the battery in EduLink S and check the battery status in the FM transmitter. (Refer to the User Guide for the FM transmitter.)
- Replace the earpiece cover (see page 17).
- Repeat the functional test.

If you still hear nothing in EduLink S, please contact the place of purchase.

Operating range

EduLink S can receive signals from up to 20 meters away. Environmental and building characteristics can decrease this figure. The following factors may contribute to reduced range:

- Installations or electronic equipment like display screens, fluorescent lighting, computers, or other IT hardware.
- Cell phone base stations or other radio transmitters.

If external interference is affecting radio reception, try switching to an alternative frequency channel. Please refer to the FM transmitter User Guide for information.

Care and maintenance:

Replacing the earpiece cover

The earpiece cover should be replaced at regular intervals, normally every 2 weeks or so.

If replacement is delayed for too long and the earpiece cover becomes blocked as a result, EduLink S user will hear transmitted speech more quietly than usual, or not at all.

Removing the earpiece cover:

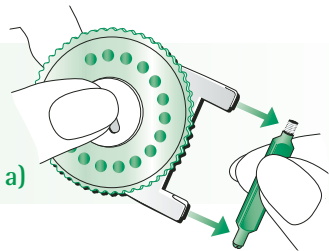

- a) Detach the replacement tool from the dispenser.

Replacing the earpiece cover

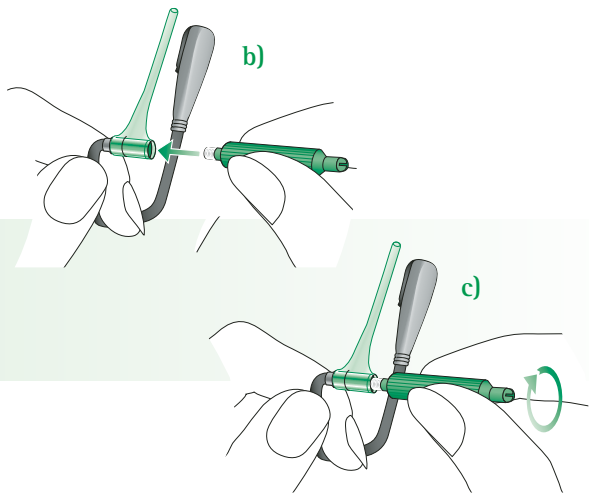

- b)** Push the **threaded end** of the replacement tool into the earpiece cover.
- c)** Twist in the thread to a depth of about 1 mm, until resistance is felt, then carefully withdraw the replacement tool with the earpiece cover attached.

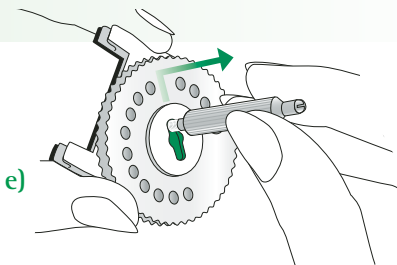
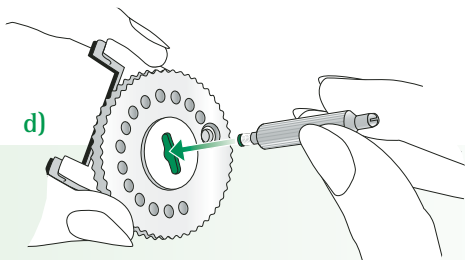

Disposal of the soiled earpiece cover:

- d) Press the replacement tool with the soiled earpiece cover into the center of the dispenser.
- e) Then slide the replacement tool sideways into the slot and pull it away from the dispenser.

Replacing the earpiece cover

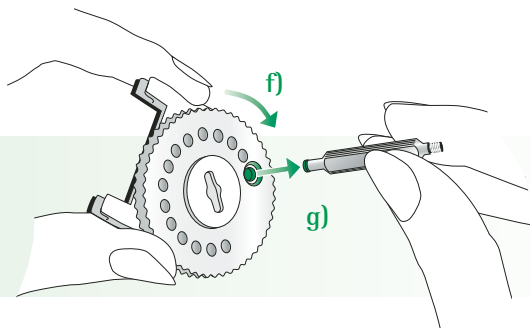

Taking a fresh earpiece cover from the dispenser:

- f) Turn the dispenser wheel to open one of the chambers.
- g) Press the tapered end of the replacement tool (not the threaded end!) into the fresh earpiece cover and withdraw it from the dispenser.

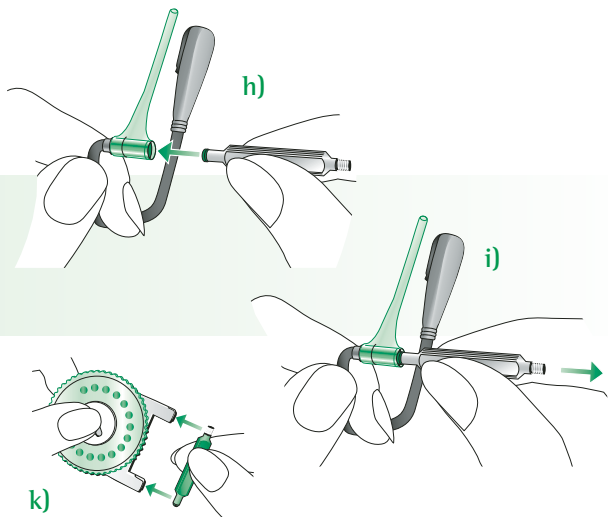

Inserting the earpiece cover

- h)** Press the earpiece cover on the end the replacement tool into the sleeve.
- i)** Withdraw the replacement tool.
- k)** Refit the replacement tool in the dispenser for safekeeping.

Fitting the childproof battery cover (optional)

a) Remove the battery.

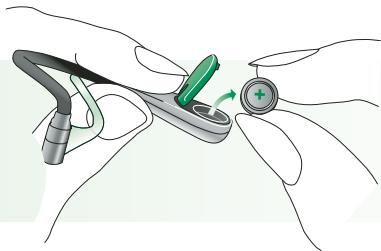

b) Lift up the battery compartment cover at a right angle and pull it away in the direction of the battery compartment.

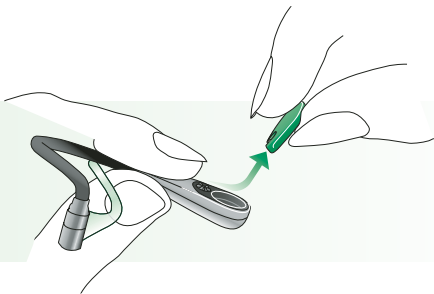

- c) Hold the screw-locking battery compartment cover at a right angle and slide it in from the side of the battery compartment.

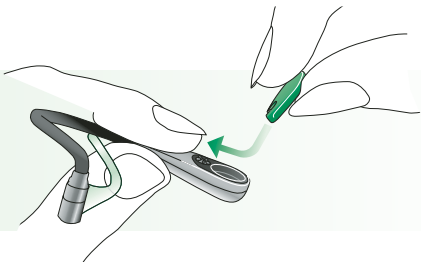

- d) Refit the battery. Ensure that the side with the + sign faces upwards.

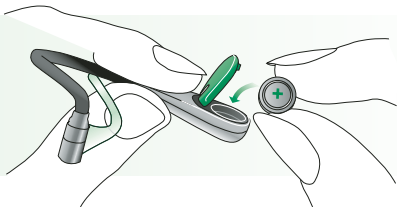

Fitting the childproof battery cover (optional)

- e) Insert both screws into the holes in the battery compartment cover and gently tighten them.

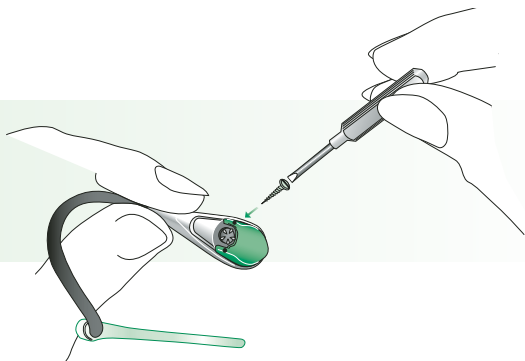

⚠ The screws must be removed each time the battery is replaced!

Changing the FM channel

- The radio receiver in your EduLink S can operate on various channels. The default channel, shown on the sticker adjacent to the battery compartment, is automatically set at switch-on.
- The FM transmitter (Campus S or SmartLink SX) can remotely switch channels in EduLink S. Please refer to the FM transmitter User Guide. Switching EduLink S off, then on again, returns it to the default channel.

Important notes

- Replace the battery regularly.
- Avoid simultaneous use of several transmitters on the same FM channel.
- Do not use water or other fluids to clean the instrument.
- Only use original Phonak accessories.
- Do not use the EduLink S in locations where the use of electronic devices is prohibited, e.g. airplanes.
- Note that FM signals can possibly be picked up and heard via other receivers.
- Before using the FM system in another country, contact the place of sale to make sure you are operating on an FM channel permitted in that country.

The EduLink S may only be repaired by an authorized agent.

Declaration of conformity

Phonak AG,
Laubisrütistrasse 28, CH-8712 Stäfa, Switzerland

Confirms that EduLink S complies with EN 300-422 and EN 301-489 guidelines including all necessary annexes.

An FM transmitter (e.g., Campus S) is required for operation with EduLink S.

The user benefit is an improved signal-to-noise ratio, which makes speech easier to hear and process.

Phonak AG

Stäfa, Switzerland

Date: March 1, 2004

Service and Warranty

Phonak provides a manufacturer's limited warranty for your EduLink S. This covers all manufacturing and material defects. Problems with EduLink S arising from improper handling or care and repairs made by an unauthorized party are not covered by the warranty. Please ask at the point of sale for full details of this warranty. The salesperson will note the serial number of your EduLink S below. It will be needed in the event of a warranty repair.

Serial number left:

Serial number right:

Date of purchase:

Phonak distributors worldwide

Group companies:	(detailed information on www.phonak.com)
Australia	Phonak Australasia Pty. Ltd. Baulkham Hills N. S. W. 2153
Austria	Hansaton Akustische Geräte GmbH 5020 Salzburg
Belgium	Lapperre N.V., 1702 Groot-Bijgaarden
Canada	Phonak Canada Limited, Mississauga, Ontario L5S 1V9
Denmark	Phonak Danmark A/S, Nitvej 10 2000 Frederiksberg
France	Phonak France SA, 69500 Bron
Germany	Phonak GmbH, 70736 Fellbach-Oeffingen
Italy	Phonak Italia S.r.l., 20159 Milano
Japan	Phonak Japan Co., Ltd., Tokyo 101-0044
Jordan	Phonak Middle East, 11181 Amman
Netherlands	Phonak B.V., 3439 ME Nieuwegein
New Zealand	Phonak New Zealand Ltd. Takapuna, Auckland 9
Norway	Phonak AS, 0105 Oslo
Spain	Phonak Iberica S.A., 03008 Alicante
Sweden	Phonak AB, 117 34 Stockholm
Switzerland	Phonak AG, Phonak Schweiz, 8712 Stäfa
United Kingdom	Phonak UK Limited Warrington, Cheshire WA1 1PP
USA	Phonak Inc., Warrenville, IL 60555-3927
Independent general agents:	A complete list of Phonak distributors is available at Phonak's Internet site: www.phonak.com . Please visit us or ask your hearingcare professional for information.
Manufacturer:	Phonak AG, Laubisrütistrasse 28 CH-8712 Stäfa, Switzerland



Notes

A series of horizontal dotted lines for writing notes.

This unit sold by:

www.phonak.com