



Solutions to improve the quality of life

**This product may be purchased from Connevens Limited secure online store
at www.DeafEquipment.co.uk**



DeafEquipment.co.uk

Solutions to improve the quality of life



EasyLink™

User Guide



PHONAK
hearing systems

CE 0682 (!)

Contents

| | |
|---|----|
| Controls | 4 |
| Welcome | 6 |
| EasyLink and accessories | 7 |
| Starting up | 8 |
| Using EasyLink | 14 |
| FM receivers | 22 |
| Important points | 24 |
| For professionals: Changing the radio channel | 25 |
| Troubleshooting | 26 |
| Declaration of conformity | 30 |
| Service and warranty | 31 |
| Phonak distributors worldwide | 32 |

Controls

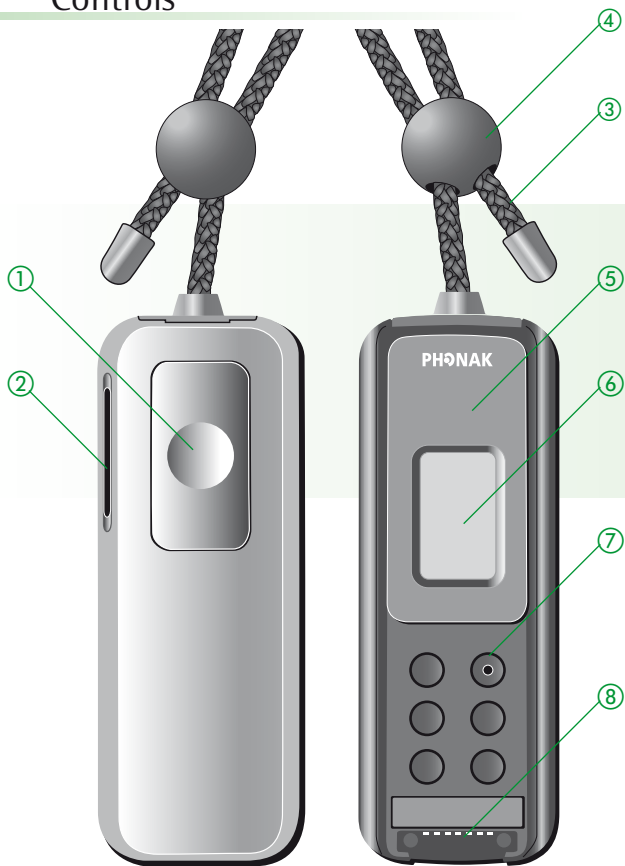

- ① On/off switch
- ② Microphone openings
- ③ Lavalier with integrated antenna
- ④ Button to adjust the lavalier length
- ⑤ Clip
- ⑥ LCD
- ⑦ For professionals:
Pen push for frequency change
- ⑧ Interface for external connections

Welcome

The new EasyLink FM transmitter is very easy to operate and delivers high sound quality. One push of the button and the finely tuned internal microphone in EasyLink picks up sound at the source and delivers it directly to the iLinks or to any other Phonak FM receivers at your ears.

To obtain maximum benefit from EasyLink, please read this user guide carefully. Ask your hearingcare professional if you have any questions.

Phonak wishes you much hearing enjoyment with EasyLink.

The following symbols appear in this user guide:



Important notes for all users.



Special notes for users of digital Phonak hearing instruments with remote control compatibility (Savia, Perseo, Claro, Supero and all future remote-controllable Phonak hearing instruments.)

EasyLink and accessories

① EasyLink _____



② Easylink home and travel case _____



③ Adapter for external connections _____



④ Audio cable _____



⑤ Charging unit _____



⑥ iLink or any MicroLink radio receiver* _____



* The type of the Phonak FM receiver depends on the hearing instrument. In the picture: MLxS

Starting up

Charging EasyLink

EasyLink contains a non-removable Lithium-ion battery with fast-charge capability. A fully discharged battery takes around 2 hours to recharge. The battery will be about 80% charged within an hour.

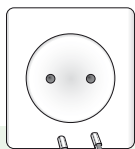

Plug the charging unit into the power socket.

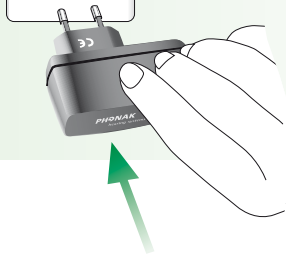

①

Attach the EasyLink adapter

②



click

Plug the charging unit into the power jack on the adapter marked  DC 7.5V



 Use only original Phonak charging units

- The battery symbol in the EasyLink display flashes during charging. The battery cannot be over-charged.
- The battery symbol stops flashing when the EasyLink is 100% charged.
- EasyLink operates for approximately 10 hours when fully charged.

Switching on/off

To switch on:
Press and hold the button for two seconds.

To switch off:
Press and hold the button again for two seconds.

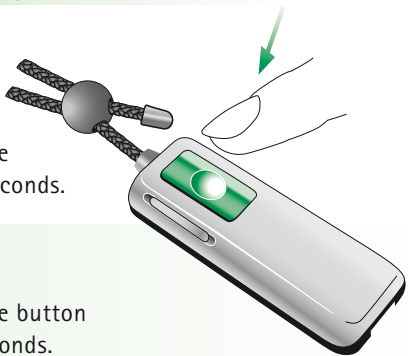

The display shows startup information during switch-on. When the EasyLink is ready, the following information appears:

- FM channel number _____
- Battery status _____

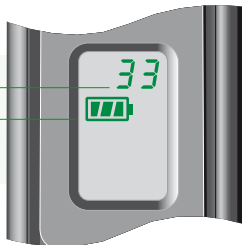

iLink and all multi-frequency MicroLink radio receivers automatically enter power-saving mode about 40 seconds after the EasyLink is switched off. Additionally, iLink automatically switches back to the "M" microphone mode.

When the EasyLink is switched on again, iLink and all Phonak multi-frequency MicroLink receivers automatically resume normal FM operation.

)))  At switch-on, the EasyLink automatically sets digital Phonak hearing instruments with remote control compatibility to the "FM + hearing instrument microphone active" program.

)))  At switch-off, the EasyLink automatically resets digital Phonak hearing instruments with remote control compatibility to the hearing instrument program.

Example:

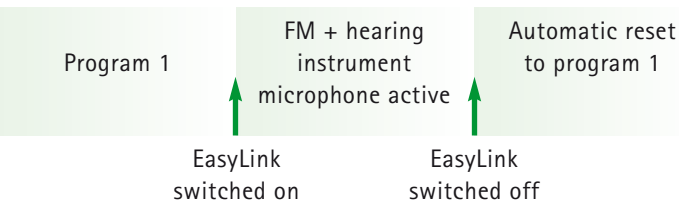

⚠ Do not cover the microphone opening with your fingers when the EasyLink is in operation. It could affect the sound quality.

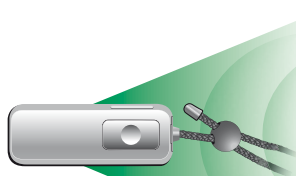
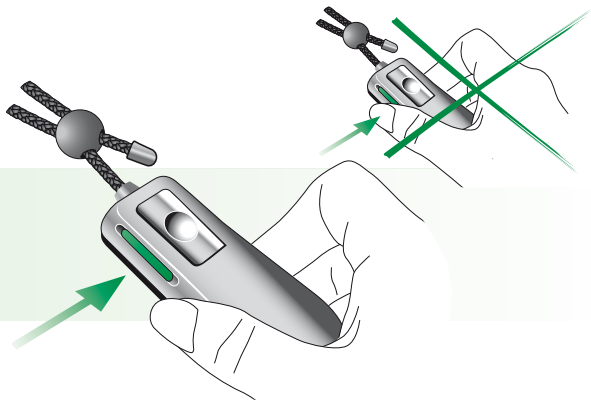

Position EasyLink so that people speak from the front into the microphones, not from the side or the back.

Operating range

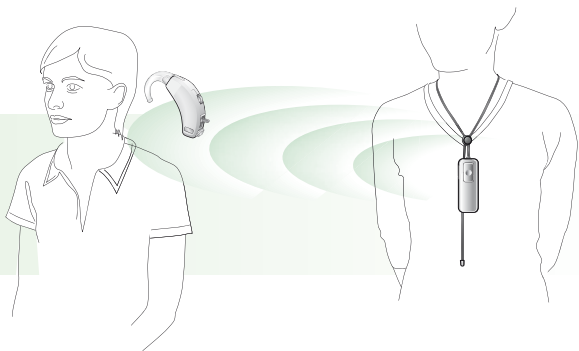

The effective operating distance between the EasyLink and the user wearing iLink or any MicroLink receivers:

- Open air – up to 30 meters (100 ft)
- Inside a building – typically up to 15 meters (50 ft)

⚠ To obtain maximum operating range, do not fold or knot the lavalier antenna.

⚠ High-power electronic equipment, larger electronic installations and metallic structures may affect and significantly reduce the operating range.

Using EasyLink

EasyLink can be used in different ways, depending on the situation. The following examples illustrate the 5 most common cases for typical Easylink use, and include a recommendation for the switch setting of iLink or of any MicroLink radio receiver.

Around a table

Recommended for:

- At business meetings
- In restaurants
- In conferences
- At home



iLink setting in practical use: "FM+M"

How to use the EasyLink:

- Place it on the table. The front of the EasyLink should point to the speakers that you want to hear.
- Make sure the lavalier is not folded together or knotted.
- Switch on the EasyLink by pressing the button for two seconds.

If the level of background noise increases, position the EasyLink closer to the speaker.

Hand-held (reporter style)

Recommended for:

- Parties
- Conversations while traveling
- Shopping



iLink setting in practical use: **"FM+M"**

How to use the EasyLink:

- Hold it in your hand. Make sure you do not cover the microphone opening on the left side of the EasyLink. The front of the EasyLink should point to the speakers you want to hear.
- Switch on the EasyLink by pressing the button for two seconds.

If the level of background noise increases, position the EasyLink closer to the speaker.

Using EasyLink

Worn by your partner

Recommended for:

- Lectures
- Walks
- Sport
- Whenever travelling with another person

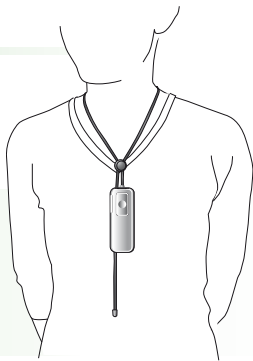

iLink setting in practical use: "FM+M"

How to use the EasyLink:

- Hand the EasyLink to your conversation partner.
- Your partner should wear it around the neck.
The cord needs to be adjusted.

 To get an optimal speech quality, make sure the distance between the speaker's mouth and the EasyLink is between 20–30 cm (8–10 inches).

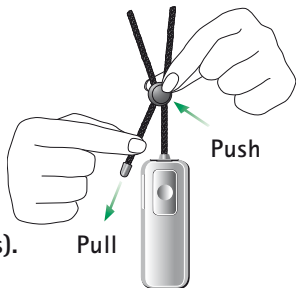

- Switch on the EasyLink by pressing the button for two seconds.

Connected to a television

Also recommended for:

- CD players, radio and other audio equipment
- Computers with an audio output
- MP3 players



iLink setting in practical use: **"FM only"**
(or **"FM+M"** while watching TV with a partner)

How to use the EasyLink:

- Connect EasyLink as pictured on page 18 and place it in front of the television.
- Switch on the television. Your Easylink will automatically switch on.
- To get maximum operating range, make sure the lavalier is not folded together or knotted.
- When the television is switched off, the EasyLink will automatically switch off after approximately 40 seconds.

Using EasyLink

Connected to a television

TV/Radio headphone output

②

Audio cable

Plug in to the audio jack

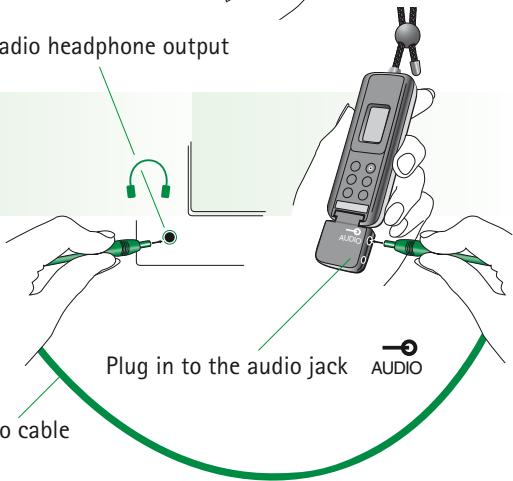

The volume of the audio output on some televisions is adjustable. Please consult the television user guide to access this feature, if available.

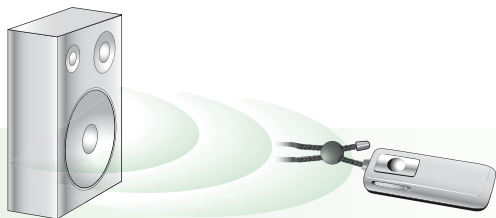

If the audio equipment does not have a headphone output socket, place EasyLink in front of the loudspeaker of the television or the radio receiver. Then switch on the EasyLink and the television.

Some televisions also have Cinch or Scart sockets. Ask your hearingcare professional for the Cinch or Scart adapter from Phonak.

Scart adapter

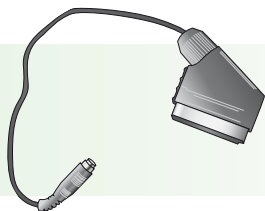

Cinch adapter

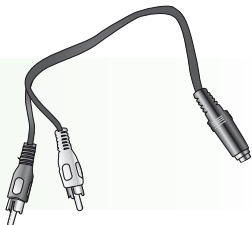

Using EasyLink

Using an external microphone

For an optimal speech quality, e.g., in educational situations in classroom and auditoriums, an external microphone can be attached to the EasyLink.

Proceed as follows:

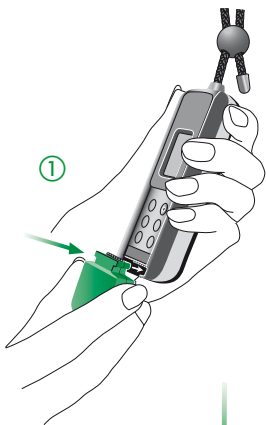

Attach the adapter to the EasyLink, then plug the microphone cable into the microphone socket of the adapter.

Hand the EasyLink to your conversation partner.

Lift the clip to secure iLink on clothing.

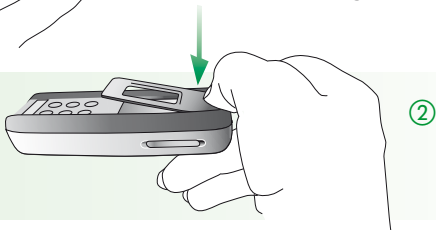

Make sure the distance between the external microphone and the mouth is between 15 and 20 cm (6–8 inches).

Switch on the EasyLink by pressing the button for 2 seconds.

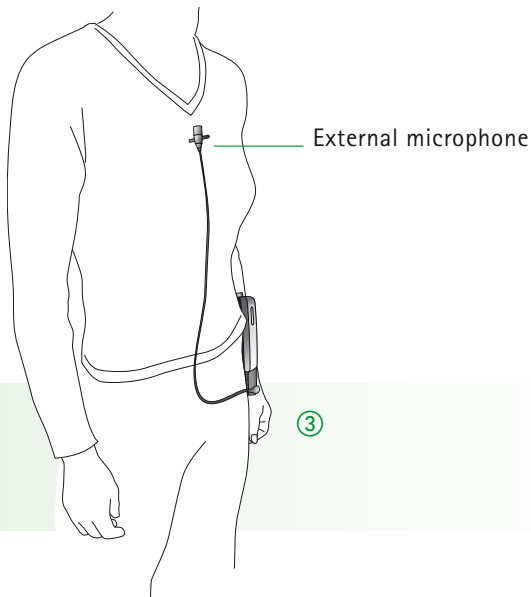

FM receivers

Setup of FM receivers

Users of iLink or Phonak hearing instruments should check recommended settings of the FM receivers in the respective hearing instrument user guide.

Principal benefits of MicroLink receivers

Default channel

iLink and MicroLink receivers are programmed with a default channel which activates at startup. It can be modified at Phonak service centers.

Channel synchronization

EasyLink can change your iLink or MicroLink receiver channel directly "over the air" within a distance of 10–20 cm (4–8 inches). This feature ensures EasyLink and the iLink or MicroLink receivers use the same radio channel.

Standby mode

This function helps economize on power. Switch off the transmitter and about 40 seconds later, your iLinks or MicroLink receivers automatically enter the standby mode. They switch to normal FM operation automatically if the EasyLink is switched on.

Switch settings on MLxS

For correct MLxS switch settings for use with Phonak hearing instruments, please refer to the respective hearing instrument user guide.

For all other hearing instrument brands, the MLxS switch setting depends on the type of the hearing instrument.

Ask your hearingcare professionals about the right switch settings for your hearing instruments.

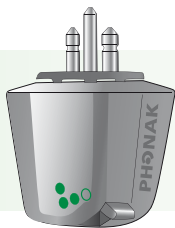

MLxS switch

Important points

- Do not use two transmitters on the same FM channel
- Do not use water or fluids for cleaning
- Use only original Phonak accessories
- Do not use EasyLink in locations where it is forbidden to use electronic devices, for instance in airplanes.
- Be aware that FM signals might also be picked up and overheard by other receivers.
- Before using the system in another country, contact your hearingcare professional to make sure your radio channel is permitted in that country.
- The EasyLink may only be repaired by an authorized service center.

For professionals:

Changing the FM channel

If the radio channel used in EasyLink is frequently disturbed by an external source of interference, the hearingcare professional can switch the EasyLink to another radio channel.

- 1) Switch on the EasyLink by pressing the button for two seconds
- 2) Using a pen, press the push button, as pictured. After one second, the channel displayed in the LCD will change. Hold the button down until the desired channel is displayed.
- 3) Release the button. The channel number in the LCD will stop blinking after a few seconds.
- 4) Set the default channel of the iLinks or MicroLink receivers to the same channel using the FM Successware.

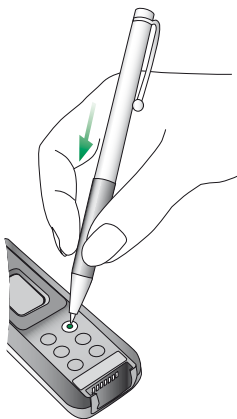

Troubleshooting

Situation

Easylink does not switch on

Poor speech intelligibility

Voices are inaudible when the EasyLink is switched on

Insufficient operating range

| Most probable cause | Remedy |
|--|--|
| Battery exhausted | Charge the EasyLink for at least two hours |
| EasyLink is positioned too far away from the speaker | Move EasyLink closer to the speaker. If EasyLink is worn with the lavalier, make sure the distance EasyLink and the mouth is 15–20 cm. |
| <ul style="list-style-type: none"> a) Hearing instrument set to the wrong program b) Radio channel not synchronized c) Receiver switched off (MLxS) | <ul style="list-style-type: none"> a) Check hearing instrument program b) Switch off the EasyLink. Hold it near to your hearing instruments (10–20 cm, 6–8 inches) and switch EasyLink back on. c) Switch MLxS to ● or ●● |
| Antenna folded or knotted | Make sure the antenna is not folded together or knotted. |

Troubleshooting

Situation

Radio interference

A second person's voice is audible

Remote-controllable Phonak hearing aids do not respond

| Most probable cause | Remedy |
|--|--|
| Extraneous cause: radio antenna or similar interfering devices nearby. | Ask your hearingcare professional to change the radio channel in the EasyLink and the default channel in the iLinks. |
| Another hearing aid user is using the same FM channel. | Ask your hearingcare professional to change the radio channel in the EasyLink and the default channel in the iLinks. |
| EasyLink and hearing instruments are too far apart when EasyLink is switched on. | Hold EasyLink closer to the hearing instruments when switching the EasyLink on (ideally < 20 cm, 8 inches). |

Declaration of conformity

Phonak AG,
Laubisrütistrasse 28, CH-8712 Stäfa, Switzerland

confirms that the EasyLink conforms to EN 300-422, EN 300-328 and EN 301-489 guidelines including all necessary annexes.

The EasyLink is used by hearing-impaired people. To operate the EasyLink, iLink or BTE hearing instruments with MicroLink receivers are required. The user benefit of FM is an improved signal-to-noise ratio, which leads to an optimized speech understanding even in very difficult listening situations.

Phonak AG

Stäfa, Switzerland

Date: May 2, 2005

Service and warranty

Phonak provides a manufacturer's limited warranty for your EasyLink. This covers all manufacturing and material defects. Problems with EasyLink arising from improper handling or care and repairs made by an unauthorized party are not covered by the warranty. Please ask at the point of sale for full details of this warranty. The salesperson will note the serial number of your EasyLink below. It will be needed in the event of a warranty repair.

Serial number

EasyLink:

Date of purchase:

Serial number FM receivers:

Phonak distributors worldwide

| | |
|-------------------------|---|
| Group companies: | (detailed information on www.phonak.com) |
| Australia | Phonak Australasia Pty. Ltd. Baulkham Hills N. S. W. 2153 |
| Austria | Hansaton Akustische Geräte GmbH 5020 Salzburg |
| Belgium | Lapperre N.V., 1702 Groot-Bijgaarden |
| Canada | Phonak Canada Limited Mississauga, Ontario L5S 1V9 |
| Denmark | Phonak Danmark A/S, Nitvej 10 2000 Frederiksberg |
| France | Phonak France SA, 69500 Bron |
| Germany | Phonak GmbH, 70736 Fellbach-Oeffingen EC Representative |
| Italy | Phonak Italia S.r.l., 20159 Milano |
| Japan | Phonak Japan Co., Ltd., Tokyo 101-0044 |
| Jordan | Phonak Middle East, 11181 Amman |
| Netherlands | Phonak B.V., 3439 ME Nieuwegein |
| New Zealand | Phonak New Zealand Ltd., Takapuna Auckland 9 |
| Norway | Phonak AS, 0105 Oslo |
| Spain | Phonak Ibérica S.A., 03008 Alicante |
| Sweden | Phonak AB, 117 34 Stockholm |
| Switzerland | Phonak AG, Phonak Schweiz, 8712 Stäfa |
| United Kingdom | Phonak UK Limited Warrington, Cheshire WA1 1PP |
| USA | Phonak LLC, Warrenville, IL 60555-3927 |

**Independent
general agents:**

A complete list of Phonak distributors is available at Phonak's Internet site: www.phonak.com. Please visit us or ask your hearing care professional for information.

Manufacturer:

Phonak AG, Laubisrütistrasse 28
CH-8712 Stäfa, Switzerland

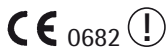

Notes

A series of horizontal dotted lines for writing notes.

This unit sold by:

www.phonak.com