

Help with telephone conversations at work



Many people at work would benefit from improved telephone listening conditions. Using a handsfree headset allows easy computer keyboard entry (without a crooked neck!) and generally improves the listening conditions for those with or without a hearing loss.

Two solutions are offered on this product sheet, both with binaural and monaural headset options.

Using a Converse telephone with a headset and converse linking cable. Alternatively a more flexible solution, which will work with a much wider range of telephones, is to use a Supra headset with Vista basestation.

The Supra headsets are hearing aid 'T' compatible, however as the 'T' signal is not strong many hearing aid users prefer listening to the telephone using a Connevens personal fm radio system - details on sheets T3a and T3b.

Using a BT Converse telephone with a Supra headset & Converse linking cable

Underneath BT Converse telephones is a socket marked 'headset' where you can plug in a Supra headset with a Converse linking cable (Pt No. 40THSUPL). The telephone may then be used with the handsfree headset or with the conventional handset.

To use the telephone with the headset, you simply press the headset button on the front of the telephone to pick up or end a call.



Converse linking Cable 40THSUPL

Only for use with Converse telephones

The headset combination may be used with any BT Converse telephone, the telephone illustrated here is the Converse 420

Using a telephone with a modular handset with a Supra Headset and Vista basestation

The Vista basestation allows headset use for any telephone, analogue or digital, that has a conventional plug in 'modular' handset.

Calls can be taken either on the handset or headset by the touch of a button.



40THVISTA

Telephone and handset

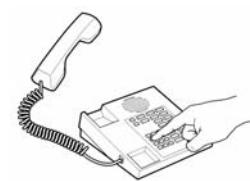

Telephone with handset plugged into side of telephone as usual

Telephone with Vista Basestation and Supra headset

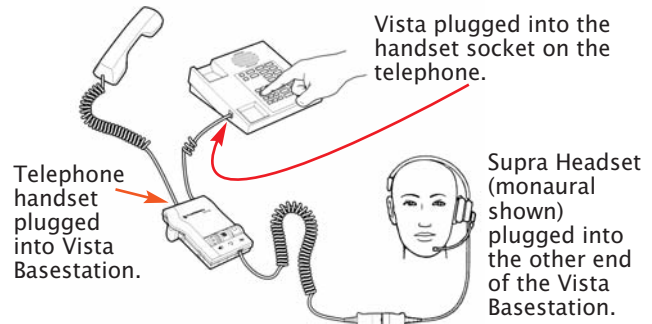

Vista plugged into the handset socket on the telephone.

Telephone handset plugged into Vista Basestation.

Supra Headset (monaural shown) plugged into the other end of the Vista Basestation.

The Vista Basestation and Supra Headset can also be used with Connevens radio systems which gives excellent telephone performance for hearing aid wearers. For more details visit our website www.connevens.com/solutions

Supra™ Headsets

The Supra headsets are light and comfortable with good sound quality. A fully adjustable headband design provides a very stable fit while the soft ear cushion buffers distracting background noise. The headsets are hearing aid 'T' compatible although the sound level is fairly low.

Monaural Headset 40THSUPM

An ideal headset which allows the user to have normal conversations without the need to remove the headset between phone calls.



Binaural Headset 40THSUPB

The Supra binaural provides sound in both ears, making it easier for anyone whose job demands total concentration when making or taking calls, particularly in a noisy environment. The binaural version is appropriate for those with two hearing aids.



Vista base adaptor

40THVISTA

The Vista basestation provides the interface between the telephone and the headset. Simple settings on the side of the Vista basestation allow the headset volume of both hearing and speaking to be adjusted to suit the telephone being used.

Uses 2 x AA alkaline batteries.



 For full details including the range of BT Converse telephones, see Connevens Catalogue, section 10 - Telecommunications